

Aluminum Gutter Systems

PROFESSIONAL GRADE .027 INCH THICK GUTTER

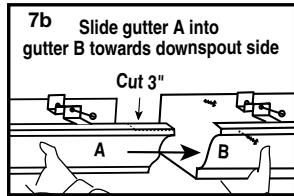
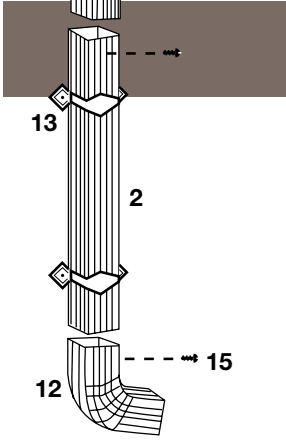
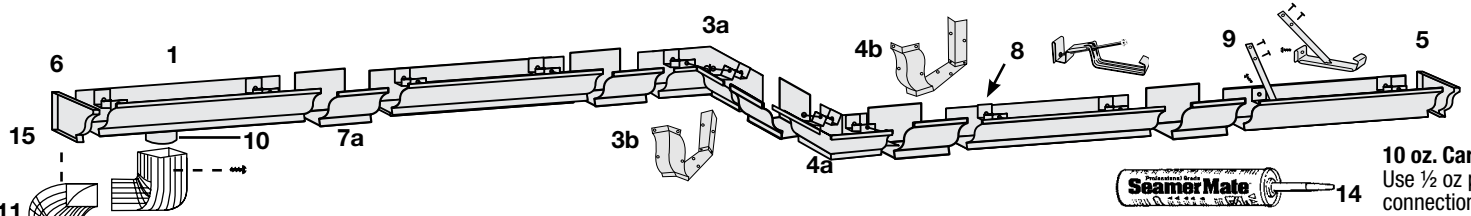

Note—6 in. gutters connect by cutting 3 in. off top lip and sliding together.

Special ORDER **19 Popular Colours to Match Any Decor.**
Colours shown as closely as modern printing process allows.

HOW TO ORDER

5 IN. OR 6 IN. GUTTERS?

- Heavy rain areas 6 in. gutter suggested
- 2 x 3 in. downspout drainage approx. 186 gal./min.
- 3 x 4 in. downspout drainage approx. 464 gal./min.
- Both downspout sizes fit 5 in. gutter

COLOUR?

- Use 3 digit code for ordering

TO ORDER:

- Take this completed form to a store sales associate
- Allow 14 working days
- Need help? Call Customer Service 800-461-5706

*056		Tuxedo Gray	*015		Royal Brown	*010		30° White	*046		Wicker
*217		Grecian Green	*218		Beaver Brown	*053		Pearl Gray	*032		Cream
*216		CB Gray	*219		Buckskin Brown	*079		Clay	*069		Almond
*221		Red	*200		Terra/Bronze	*231		Ivory	*220		Herringbone
			*059		Musket Brown	*025		Black	*230		Bone Linen

* Indicates Colour Code

5 inch System

Description	Model #	Qty.
1 Gutter: 10 ft. sections (5 in.)	24002	*
2 Downspout: 10 ft. (2 in. x 3 in.)	24019	*
3a Inside Mitre: (5 in.)	25001	*
4a Outside Mitre: (5 in.)	25002	*
5 Right End Cap: (5 in.)	25006	*
6 Left End Cap: (5 in.)	25005	*
7a Seamer: 2 per pack with 1 oz. SeamerMate™ (Available in 5 in. only)	25008	*
8 Hidden Hanger with Hex Head Screw: (5 in.)	21812	
9 Hidden Hanger with Roof Strap 4 pk. Nails Included No Fascia Board Available (5 in. only)	21030	
10 Unpainted Outlet: (2 in. x 3 in.)	21051	
11 Front Elbow A: (2 in. x 3 in.)	25064	*
12 Side Elbow B: (2 in. x 3 in.)	25065	*
13 Downspout Band	25029	*
14 SeamerMate™ 10 oz. Cartridge	85184	*
15 Sheet Metal Screws: 8 Per Pack	85354	*

6 inch System

Description	Model #	Qty.
1 Gutter: 10 ft. sections (6 in.)	44002	*
2 Downspout: 10 ft. (3 in. x 4 in.)	44011	*
3b Inside Strip Mitre: (6 in.)	45003	*
4b Outside Strip Mitre: (6 in.)	45004	*
5 Right End Cap: (6 in.)	45006	*
6 Left End Cap: (6 in.)	45005	*
7b No Seamer required (see illustration) – SeamerMate™ sealant required		
8 Hidden Hanger with Hex Head Screw: (6 in.)	47814	
9 N/A		
10 Unpainted Outlet: (3 in. x 4 in.)	47051	
11 Front Elbow A: (3 in. x 4 in.)	45064	*
12 Side Elbow B: (3 in. x 4 in.)	45065	*
13 Downspout Band	25029	*
14 SeamerMate™ 10 oz. Cartridge	85184	*
15 Sheet Metal Screws: 8 Per Pack	85354	*

Special ORDER
Copper Gutter on other side



26 Lorena Street
Barrie, Ontario L4N 4P4

Customer Service:
T 800.461.5706
F 800.731.0385
E canadainfo@euramax.ca

Half Round Copper Gutter Systems



Special ORDER Accent Your Home in Classic Copper.
To place an order, see a store sales associate.



5 inch System			
Gutter and Downspouts			Qty.
1	52006	5 in. half round gutter, 10 ft.	_____
2	52032	3 in. smooth downspout, 10 ft.	_____
3	52308	3 in. round corrugated downspout, 10 ft.	_____
Gutter Components			
4	8600081	5 in. #10 combo, fascia mounted	_____
or 5	355251	5 in. rival, roof mounted	_____
or 6	860131	5 in. circle with spring clip (requires a shank below)	_____
and 7	350001	#10 fascia shank	_____
8	350003	#12 roof shank	_____
9	350005	#30 adjustable fascia shank	_____
10	530091	slip joint connector	_____
11	53515	6 in. half round endcaps	_____
12	535011	5 in. inside half round box mitre	_____
13	535021	5 in. outside half round box mitre	_____
14	85455	5 in. half round gutter guard, 3 ft.	_____
Downspout Components			
15	350591	3 in. wire strainer	_____
16	533511	3 in. half round outlet	_____
17	533641	3 in. plain round 75 deg. elbow	_____
18	533064	3 in. round corrugated 75 deg. elbow	_____
19	35129	3 in. conductor band	_____

6 inch System			
Gutter and Downspouts			Qty.
1	60621	6 in. half round gutter, 10 ft.	_____
2	52142	4 in. smooth downspout, 10 ft.	_____
3	52404	4 in. round corrugated downspout, 10 ft.	_____
Gutter Components			
4	8600101	6 in. #10 combo, fascia mounted	_____
or 5	356251	6 in. rival, roof mounted	_____
or 6	860132	6 in. circle with spring clip (requires a shank below)	_____
and 7	350001	#10 fascia shank	_____
8	350003	#12 roof shank	_____
9	350005	#30 adjustable fascia shank	_____
10	530101	slip joint connector	_____
11	60615	6 in. half round endcaps	_____
12	5360110	6 in. inside half round box mitre	_____
13	5360210	6 in. outside half round box mitre	_____
14	85456	6 in. half round gutter guard, 3 ft.	_____
Downspout Components			
15	530591	4 in. wire strainer	_____
16	534511	4 in. half round outlet	_____
17	534641	4 in. plain round 75 deg. elbow	_____
18	534064	4 in. round corrugated 75 deg. elbow	_____
19	35130	4 in. conductor band	_____

K-style Copper Gutter also available - service options:

1. See a store sales associate for assistance with your order
2. Visit www.euramaxcanada.com/productsKgutter.html, click "Catalogue" link
3. Call Euramax Canada Customer Service, 800-461-5706